



L & LT HIGH FLOW SERIES: *Non Pressurized Fluid* Sampling Instructions

✓ PREPARE

Tools Required:

- Vacuum Pump (VAC)
- Sampling Probe (SLF4)
- 16 oz. Purge Bottle (L-16) or 4 oz (LC)
- Length of 1/4" OD Tubing (SER4)
- Sample Bottle (LC)

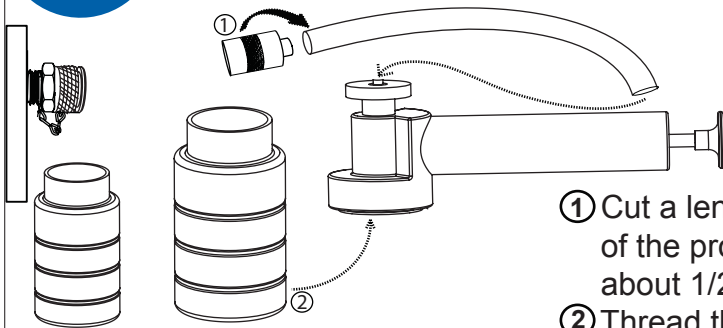

- ① Cut a length of new disposable tubing and insert onto barb of the probe. Place the other end into the vacuum pump about 1/2" into the bottle. Tighten the knurled nut snug.
- ② Thread the purge bottle onto the vacuum pump.

✓ CONNECT

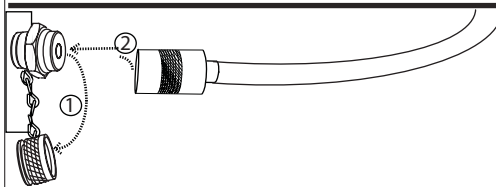

- ① Remove the metal cap on the L/LT valve and ensure the valve face is clean.
- ② Thread the probe onto the sampling valve.

✓ PURGE

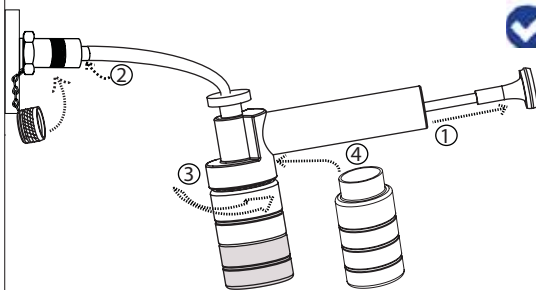

- ① Pull the handle back several strokes to draw 0.8oz/24ml of fluid into the purge bottle for sampling tubes up to 24"/610mm. Call for recommended purge volumes on remote hose installations and tube lengths longer than 24 inches.
- ② Unthread the probe only two threads to stop the flow.
- ③ Remove the purge bottle from the vacuum pump.
- ④ Replace with a new, clean sample bottle.

✓ SAMPLE

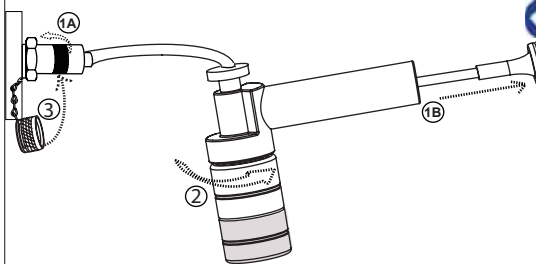

- ①A Rethread the probe onto the valve and ①B draw 3 oz/90ml of fluid to the fill mark.
- ② Unthread the probe two turns to stop the flow and suction the line clear of fluid or loosen the bottle.
- ③ Remove the bottle in a zip bag or in an area free from contamination.

✓ DISPOSE



- ① Unthread the probe completely from the sampling valve.
- ② Dispose of the plastic tubing and purge oil responsibly. An extra zip bag can hold tubing and a purge oil bottle.

✓ SEND



- Complete the paperwork and send the bottle as soon as possible to the lab to reduce the risk if action is required.



Lubrication Technologies, Inc.
120 Bosworth Street
West Springfield, MA 01089

413-788-LUBE (5823)
Fax 413-218-5823
www.LubeTechnologies.com